

Pratt Institute  
Main Campus

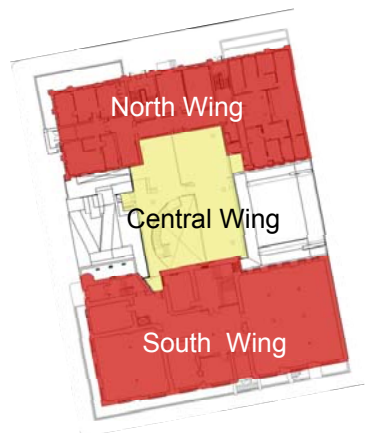

Higgins  
Hall

Higgins Hall:



North Wing

Central Wing

South Wing

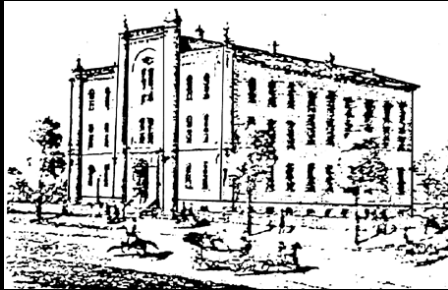

**1868**  
Adelphi Academy



**1996**  
Fire destroys Central Wing,  
damages rest



**1999**  
North Wing in use



**1965**  
Pratt acquires  
the complex; it is  
renamed Higgins  
Hall



**1999**  
North Wing completed



**2003**  
South Wing completed  
Utility and circulation cores  
constructed in North and  
South Wings to serve later  
Central Wing;



**2005**  
Central Wing completed



2005 Pratt Institute School of Architecture, Higgins Hall. From left to right: North Wing, Central Wing, South Wing



New attic studio, North Wing



New Studio, South Wing. Using natural daylighting and other sustainable materials and finishes, this participated in the LEED-CI pilot program.



All spaces are treated in dynamic ways. Central Wing basement hallway, left; South Wing stairway with balcony overlook and “crit” space, right.



Similar material and spatial strategies throughout the building celebrate different eras of construction techniques, while creating a contemporary workspace for architecture. New student review spaces in the Central Wing (left) and North Wing (right) with balcony overlooks.



Student Workspaces, North Wing



The floor plates of the North and South Wings are not at the same level. The oversized ramp in the Central Wing resolves this difference at all three floors.



Central Wing, South Wing, and courtyard.